

INDICATORS

240V BEZEL

Red, spade lug connections, small round flat end. 10mm diameter. 45mm length. Cut out hole 9mm



Part Number
SL2630

220V NEON

220V AC panel mount red neon. Mounting hole 10mm??



Part Number
S4016

250V CHROME BEZEL NEON

220V AC panel mount chrome bezel red neon. Mounting hole 8mm??



Part Number
S4015

220V MINATURE NEON

220V AC panel mount miniature red neon. Mounting hole 4.5mm??



Part Number
S4020

240V CHROME BEZELS

Length 32mm with 70mm leads. Panel hole 7mm



Part Number	Type
SL2632	Red
SL2633	Green

MES FILAMENT GLOBES

Standard MES globe and plain metal lamp holder.?

Part Number	Type
S4045	6V 500mA
S4047	12V 250mA
S4055	Base



LILLIPOT GLOBES

Total length 17mm Width 4.5mm Glass length 8mm

Part Number	Type
SL2650	6.3V
SL2652	12V



PIGTAIL NEON

????? V AC. Requires series resistor depending on operating voltage.

Part Number	R=240? @ 240V AC
S4010	



LOW VOLTAGE BEZELS

Accepts Lilliput globes. Panel hole 10mm Length 29mm Requires globes SL2650 or SL2652

Part Number	Type
SL2620	Red
SL2622	Green



12V BEZEL - LARGE

Perfect for car alarms. Orange lens measures 20 x 20mm. Panel hole 15mm

Part Number
SL2694



12V PANEL LAMPS

12V panel mount lamp indicators. ?

Part Number	Type
S4025	Red
S4026	Green



Mounting hole 7mm??

3MM LED BEZELS

Chrome housing, 2V. 5mm panel hole

Part Number	Type
SL2615	Red
SL2616	Green



5MM LED BEZELS

Chrome housing, 2V. 8mm panel hole

Part Number	Type
SL2610	Red
SL2612	Green



12V MINI CHROME BEZELS

3mm LED in chrome casing 10mm long. Hole cut out 5mm. Includes flying leads and dropping resistor.

Part Number	Type
SL2644	Red
SL2645	Green



SEE ALSO LEDS ON PAGE

INDUCTORS- FERRITES

FERRITE AERIAL ROD

Material - F14 Ferrite
Wavelength - up to 12MHz
Part No. - 9.5 x 200-F14
Dimensions - 9.5mm? x 200mm



Part Number
L5240

SUPPRESSION BEADS

Designed for suppression of electromagnetic interference. A range of beads is available covering a wide frequency band.



Dimensions (mm)

Part Number	Type	OD	ID	Length
L4710	F8	7.7	3.4	17.7
L4810	F19	12.3	4.87	25.4
L4820	F19	14.3	7.3	28.8
L4830	F19	28.5	12.3	28.5
L4910	F14	7.9	3.65	15.8

TOROIDAL CORES

"Powdered Iron" type. For use in power supplies, RF suppression, chokes.

Grade - 1003
Saturation Flux Density - 15000gauss
Max. Operating Frequency - 500 kHz



Part Number	OD (mm)	ID (mm)	Height (mm)	Neosid Part
L5110	14.8	8	6.35	17-732-22
L5120	33	20	10	17-742-22
L5130	44	24	16.5	17-745-22

BALUN CORES

Neosid Part No. - 35-032-28
Operating Frequency - 50-500kHz
Material - F8 Ferrite



Part Number
L5250

Outside Diameter - 4mm
Inside Diameter - 2mm
Length - 5mm

TRANSFORMER POT CORES

Outside Diam - 26mm
Inside Diam - 11.1mm
Height - 16mm
Material - F5A

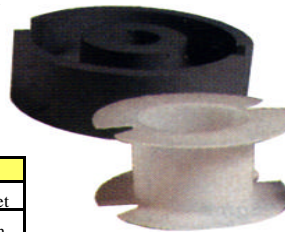

Ferrite equivalent to FX2240 pot core

Part Number	Type
L5300	Core Set
L5305	Bobbin

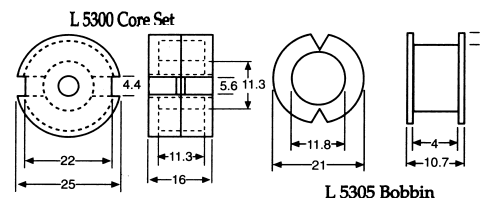

SUB MINIATURE FORMER KIT

5mm type 722-1 - used with 4mm F16 slug or as open air type.

Supplied as complete kit.

Part Number
L5210



BALUN CORES

L5230
Neosid Part No. - 1050-1-F14
Operating Frequency - 40-220MHz
Material - F14 Ferrite
Dimensions(mm) - 7.4 x 13.2 x 13.5



L5235
Neosid Part No. - 1050-2-F14
Operating Frequency - 40-220MHz
Material - F14 Ferrite
Dimensions(mm) - 7.4 x 13.2 x 6.6



Part Number
L5230
L5235

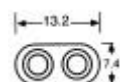

MULTI APERTURE CORE

These cores are also used in balun transformers as well as transformer chokes for VHF/UHF communication systems.
Outside Diameter: 6mm
Length: 10mm
Hole Diam: 0.8mm



Part Number
LF1224

PREWOUND FERRITE CHOKE

Ideal for all wideband choke applications, especially switchmode power supplies etc.
Rated Current: 5Amp @ 100VAC
Inductance min: 100? H
Rdc max: 50m? ?
Winding wire diam.: 1.0mm
Weight: 20grams ?

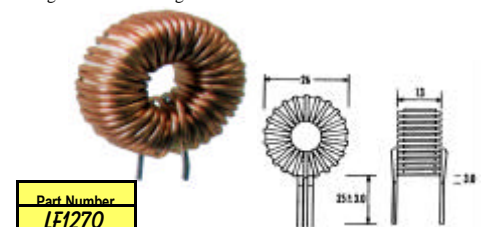

Part Number
LF1270